

# OWL

## BUILDING INSTRUCTIONS

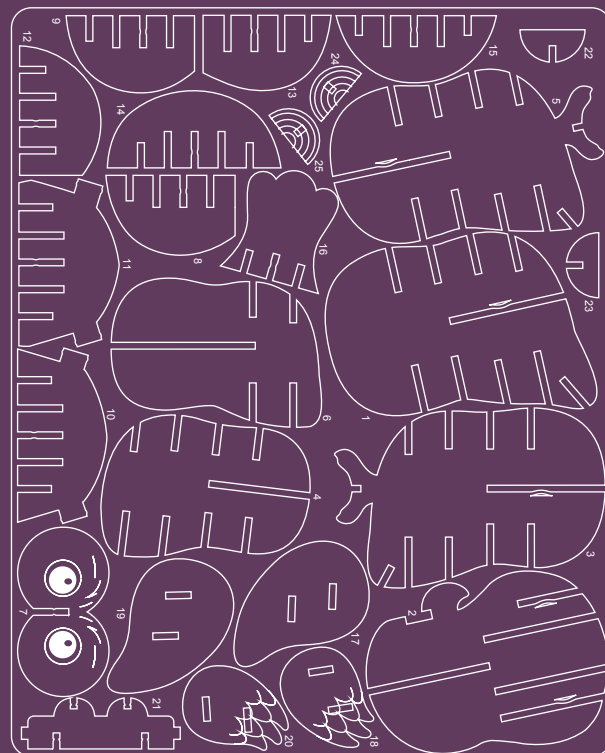

Manufactured in Shaoguan, China 062016

Copyright © 2016 by Insight Editions, LP

### READ BEFORE ASSEMBLING:

- Go through the instructions one step at a time.
- Don't punch out all of the pre-cut parts at once.
- Plywood thickness and color may vary.
- While not necessary, glue may be applied if desired.
- Adult supervision recommended.

**WARNING: CHOKING HAZARD - CONTAINS SMALL PARTS. NOT FOR CHILDREN UNDER 3 YRS.**

## MAKE IT YOUR OWN

Before you start building and decorating your model, read through the instructions so you understand how it all comes together. Then make a plan—glittery or gloomy? What about a punk-rock owl? The choice is yours! Here is an example of a traditional owl to get those creative juices flowing.

### PLAN

For this project, assemble everything except for the eyes, wings, and log. Paint those separately and attach when dry.

### TECHNIQUES

Use a small brush to get the paint into all the nooks and crannies. You may want to do two coats on the edges to make sure they are all covered.



### COLORS

Using more than one shade of brown will add more variety to your model. Owls typically have very mottled-looking feathers.

### ACCESSORIZE

Add feathers by making short, light brushstrokes across the model. You can design them in a pattern as shown on the head pictured here, or paint them randomly as shown on the body.



Incredibuilds™, a division of Insight Editions LP

1



2

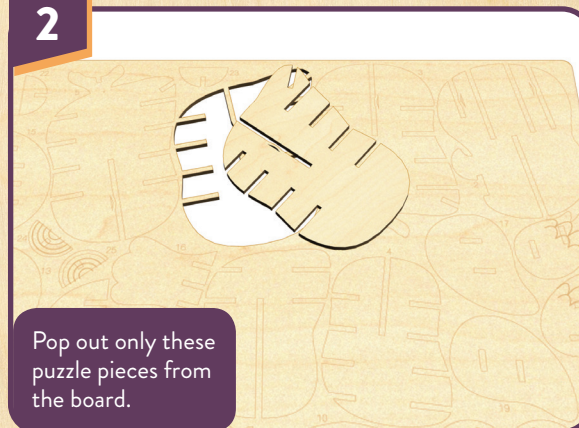

3

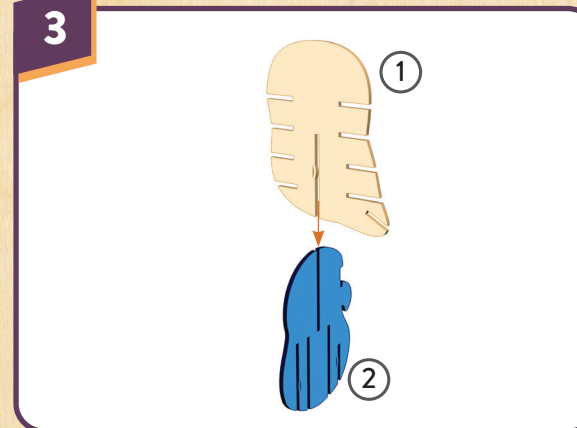

4

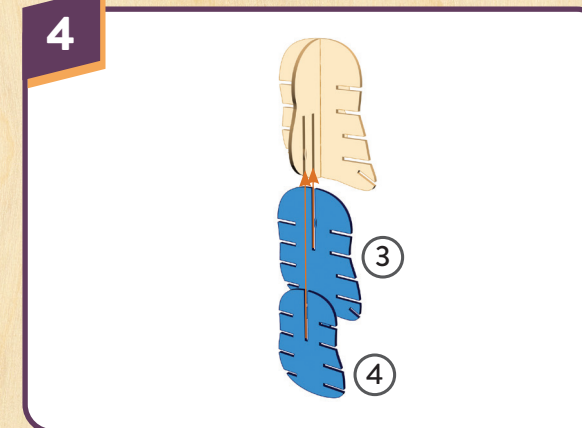

5

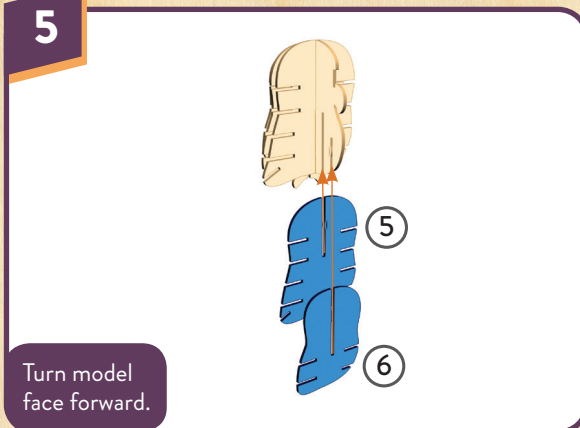

6

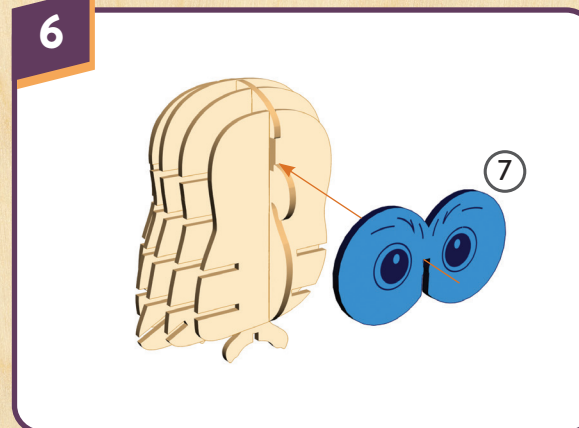

7

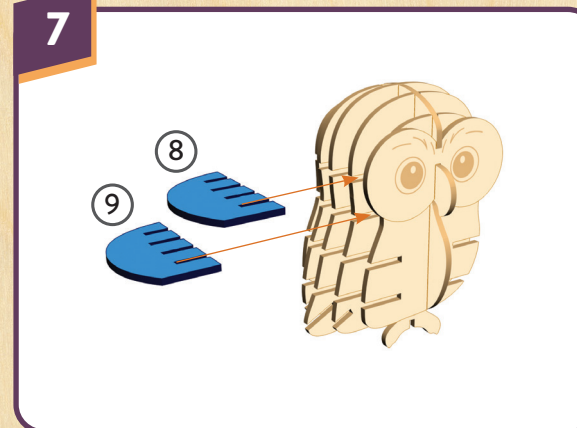

8

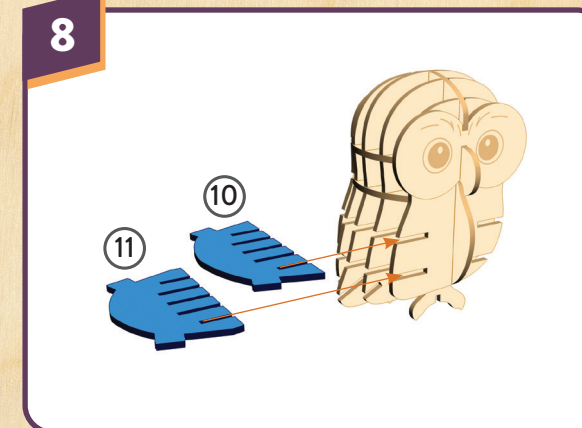



9

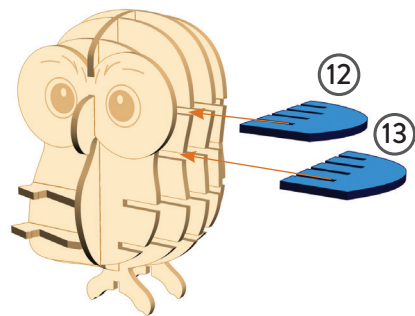

10

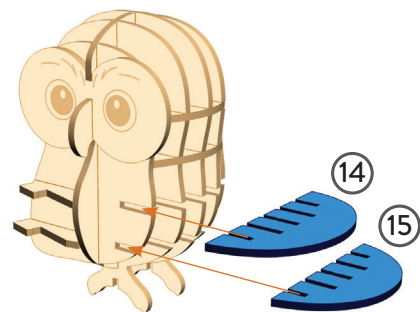

11

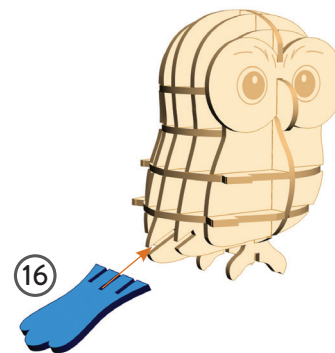

12

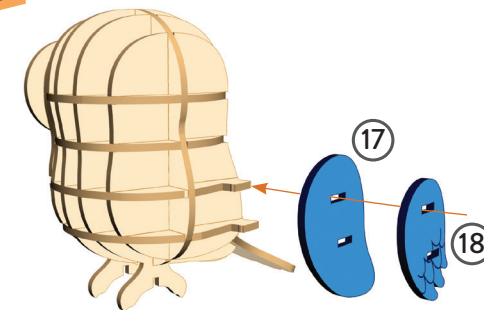

13

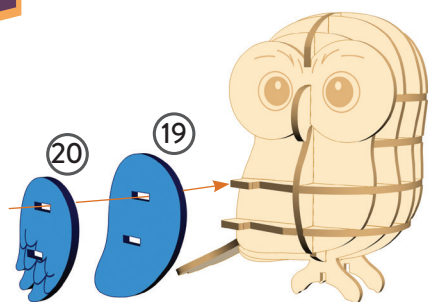

14

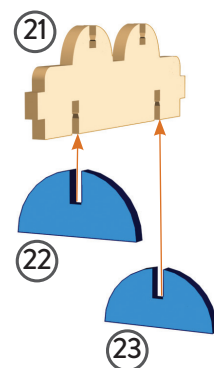

15

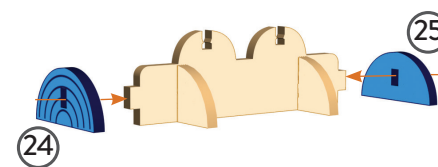

16

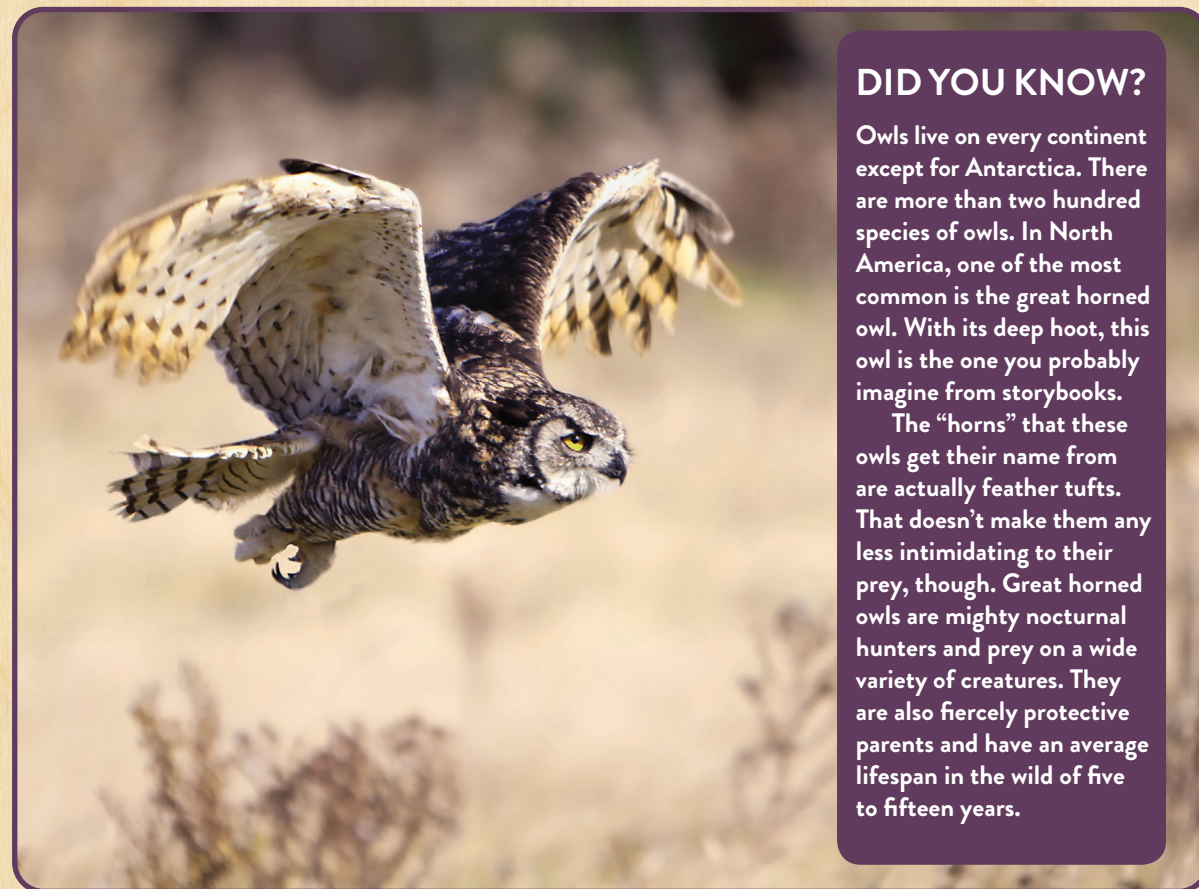
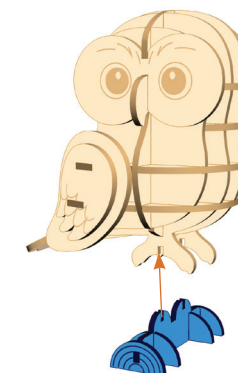

### DID YOU KNOW?

Owls live on every continent except for Antarctica. There are more than two hundred species of owls. In North America, one of the most common is the great horned owl. With its deep hoot, this owl is the one you probably imagine from storybooks.

The "horns" that these owls get their name from are actually feather tufts. That doesn't make them any less intimidating to their prey, though. Great horned owls are mighty nocturnal hunters and prey on a wide variety of creatures. They are also fiercely protective parents and have an average lifespan in the wild of five to fifteen years.