

# STAR WARS

## MILLENNIUM FALCON

### BUILDING INSTRUCTIONS



#### READ BEFORE ASSEMBLING:

- Go through the instructions one step at a time.
- Don't punch out all of the pre-cut parts at once.
- Plywood thickness and color may vary.
- While not necessary, glue may be applied if desired.
- Adult supervision recommended.

**WARNING: CHOKING HAZARD -**  
CONTAINS SMALL PARTS.  
NOT FOR CHILDREN UNDER 3 YRS.

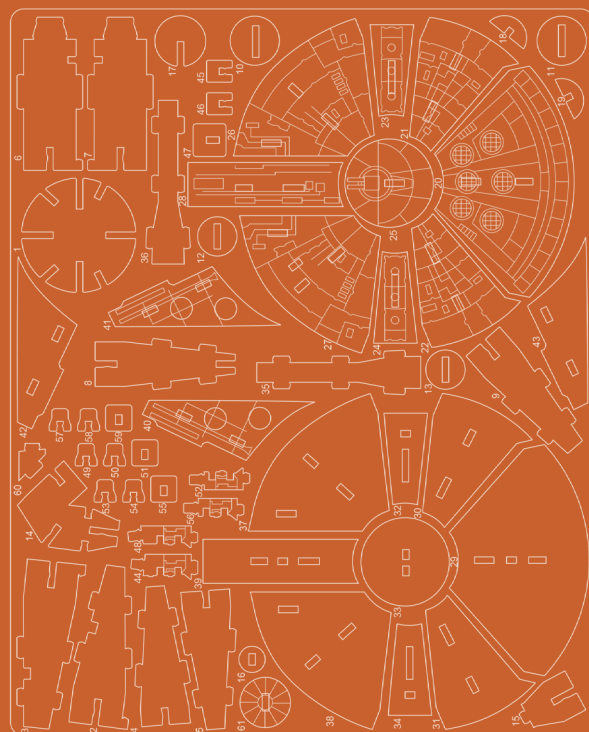

Manufactured in Shaoguan, China 13102016

™ & © 2016 LFL

1

Match the board pieces to the numbers on the board image above to find your first two pieces.

2

Pop out only these puzzle pieces from the board.

3



Note the direction of piece 1 for the next two steps.

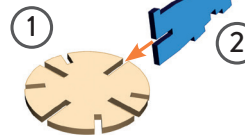

To put the two pieces together, match up the slots on each piece. Slide together.

4

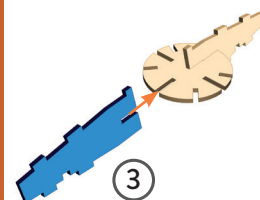

Continue assembling by putting pieces together in numerical order.

5

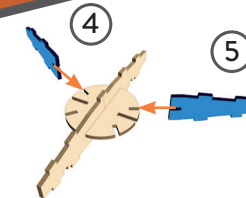

Don't push these pieces all the way to the center. Just push them until they are securely attached.

6

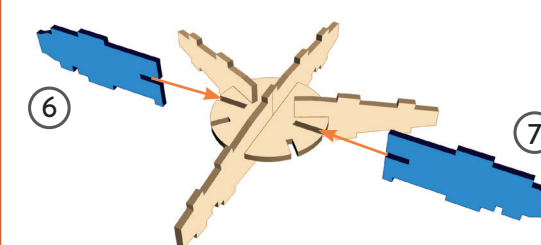

Push these pieces all the way to the center.

7

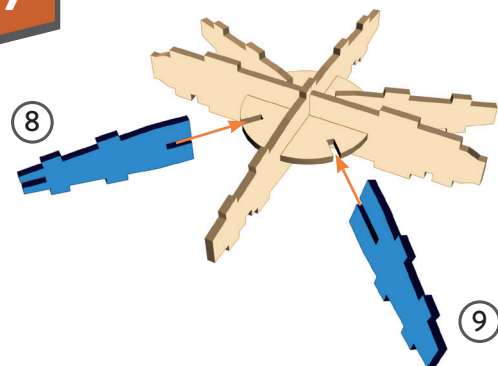

8

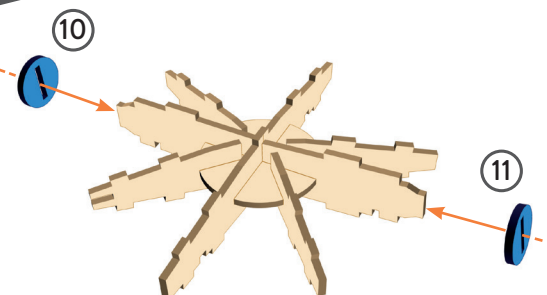

11

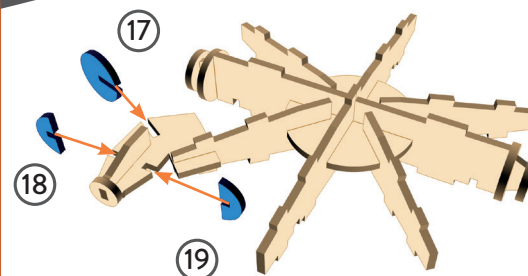

12

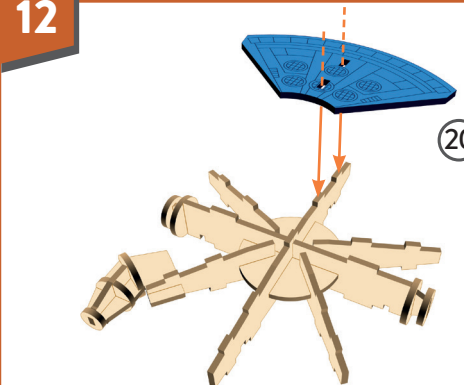

9

Note that there will be a small gap between the pieces from step 8 and the pieces 12 and 13 added here.



10

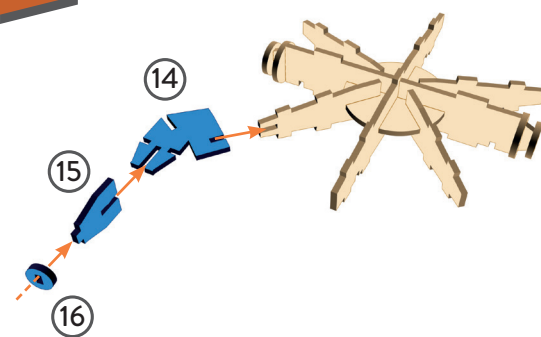

13

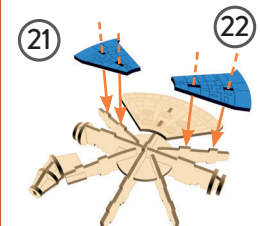

14

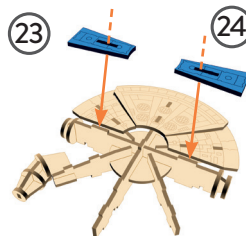

15

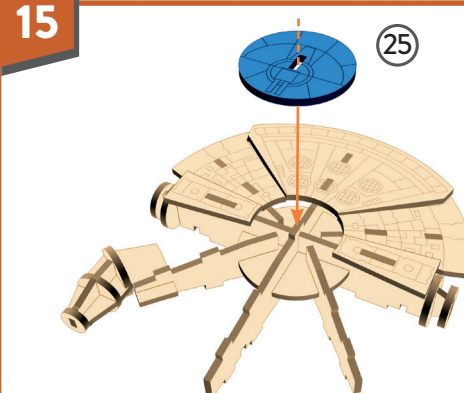



16

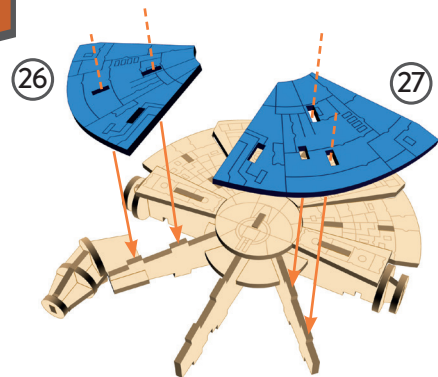

17

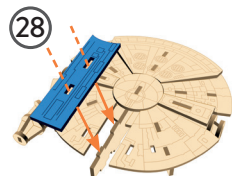

18

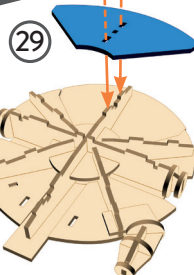

Turn the model upside down to place piece 29.

21

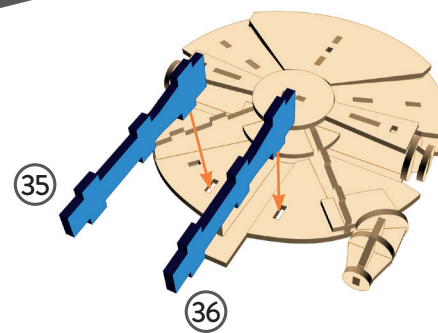

22

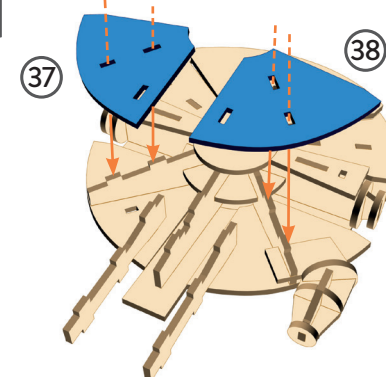

19

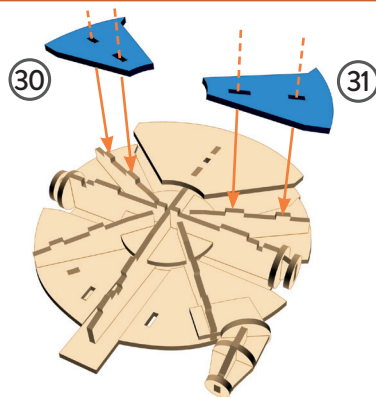

20

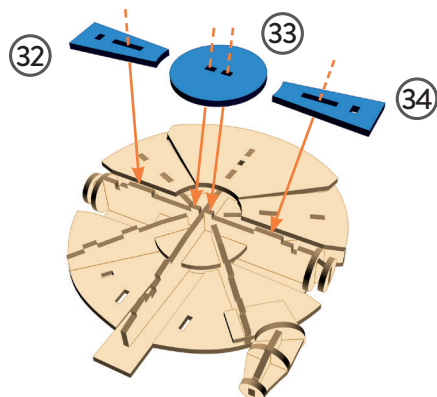

23

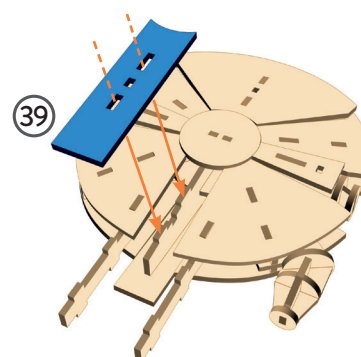

24

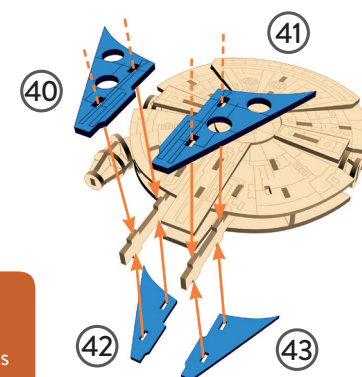

Flip the model over so the engraved side is on top.

25

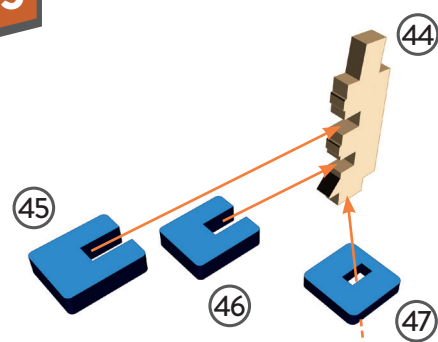

26

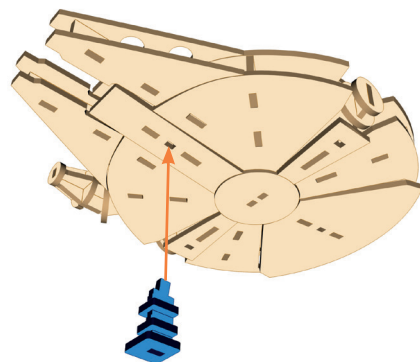

29

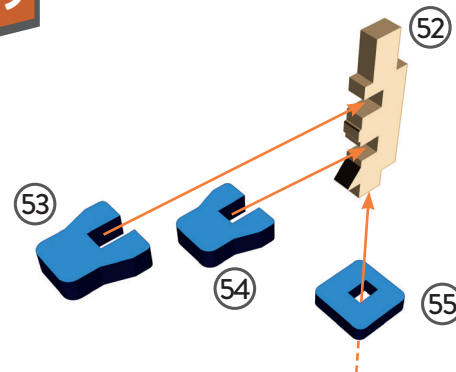

30

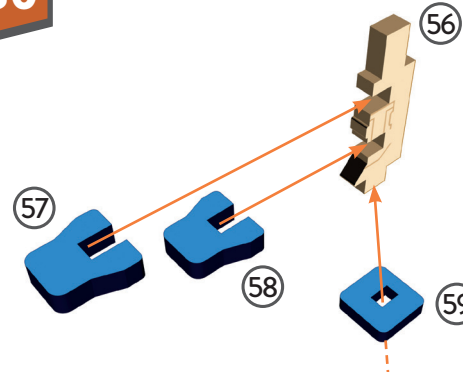

27

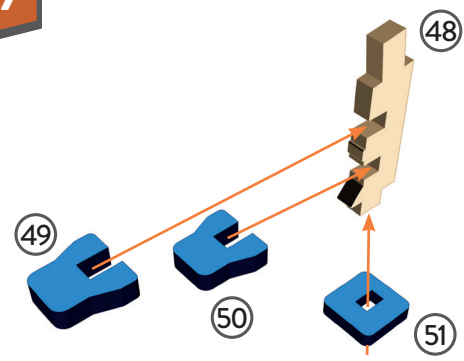

28

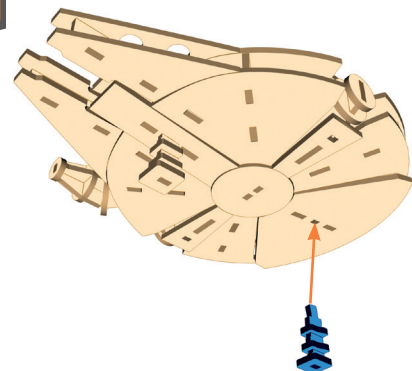

31

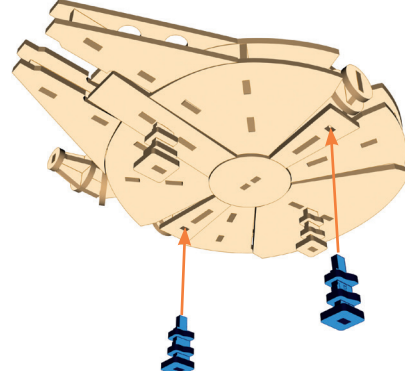

32

