

NEW YORK EMPIRE STATE BUILDING BUILDING INSTRUCTIONS

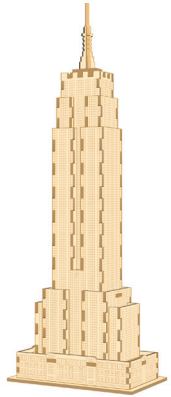

READ BEFORE ASSEMBLING:

- Go through the instructions one step at a time.
- Don't punch out all of the pre-cut parts at once.
- Plywood thickness and color may vary.
- While not necessary, glue may be applied if desired.
- If you have trouble punching out the small pieces from the board, use tweezers or a toothpick to help.
- Adult supervision recommended.

WARNING: CHOKING HAZARD -
CONTAINS SMALL PARTS.
NOT FOR CHILDREN UNDER 3 YRS.

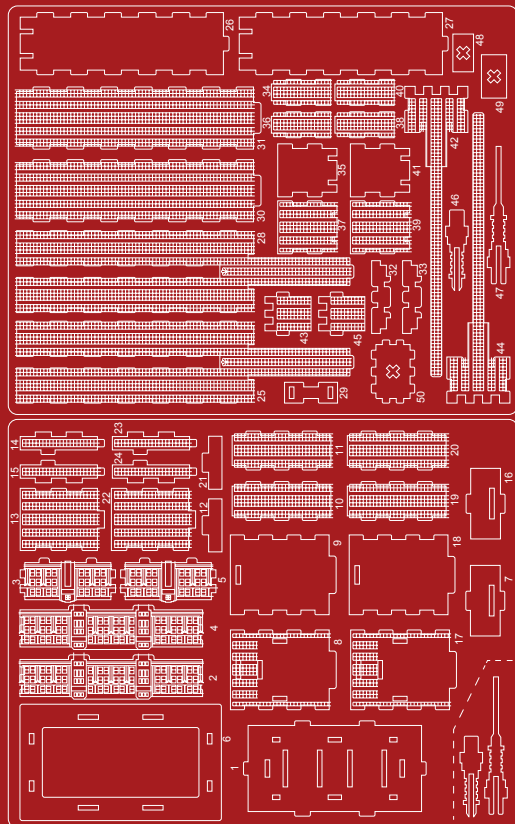

Manufactured in Shaoguan, China 41112016

Copyright © 2016 by Insight Editions, LP

1

Match the board pieces to the numbers on the board image above to find your first two pieces.

2

Pop out only these puzzle pieces from the board.

3

To put the pieces together, match up the slots on each piece. Slide together.

4

Continue assembling by putting pieces together in numerical order.

5

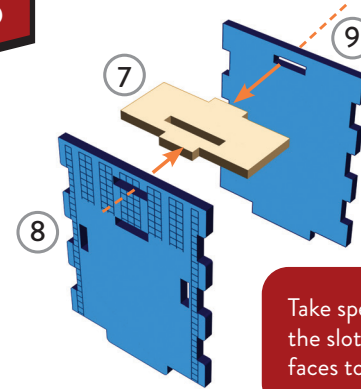

Take special note that the slot on piece 7 faces toward piece 8.

6

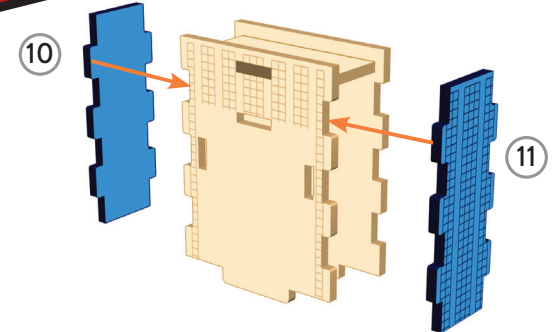

7

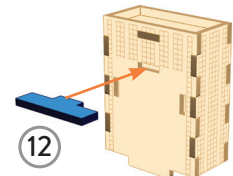

8

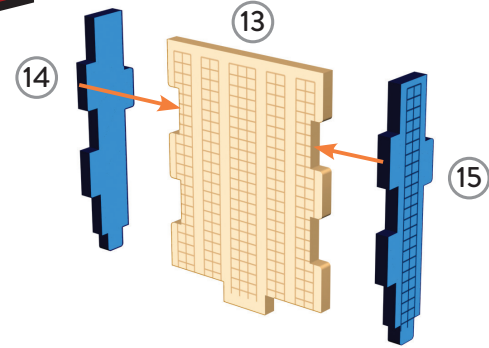

9

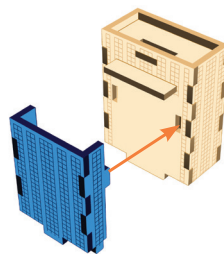

10

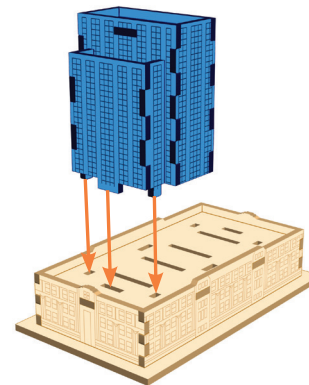

11

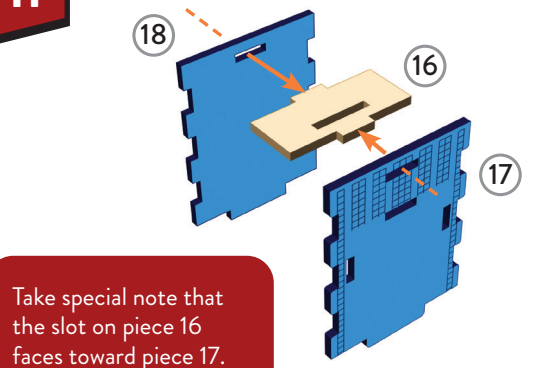

Take special note that the slot on piece 16 faces toward piece 17.

12

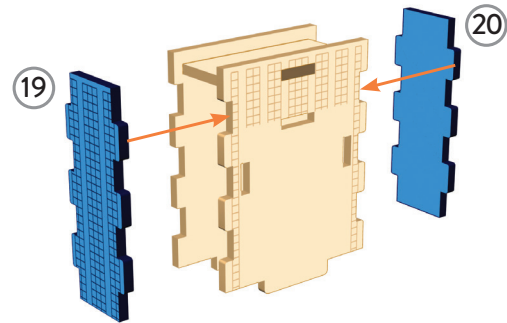

13

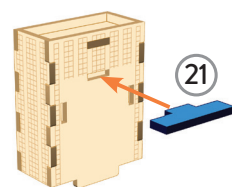

14

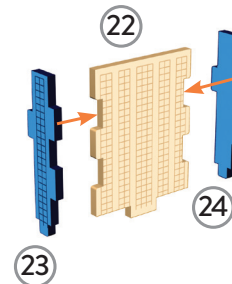

15

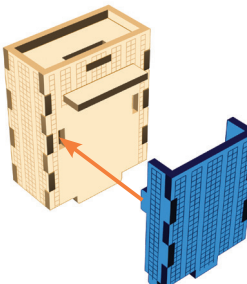

16

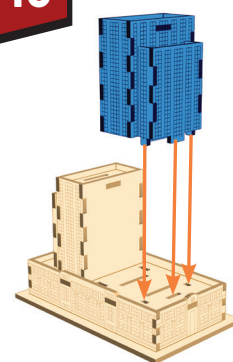

17

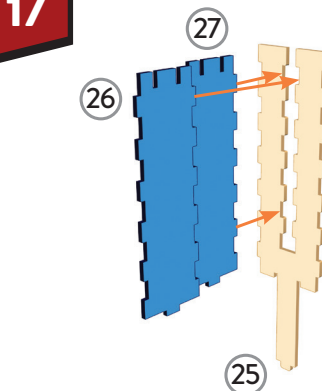

Pay close attention to the pictures to see which way the engraved pieces face.

18

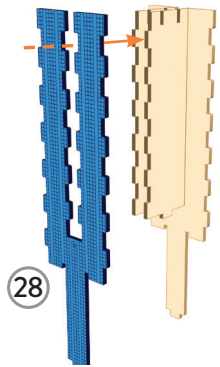

19

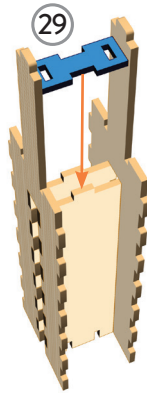

20

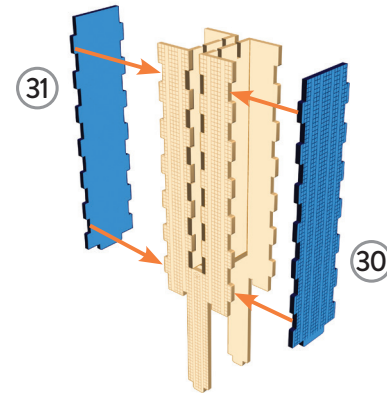

21

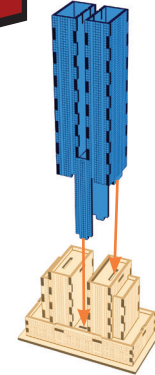

22

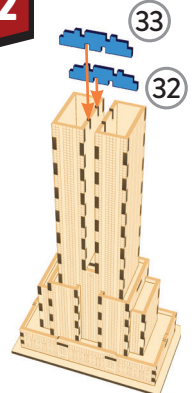

23

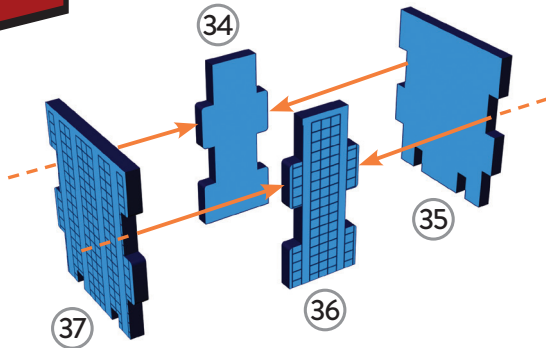

24

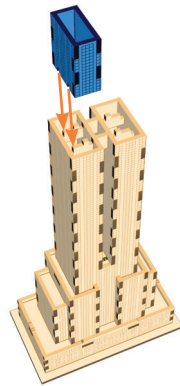

25

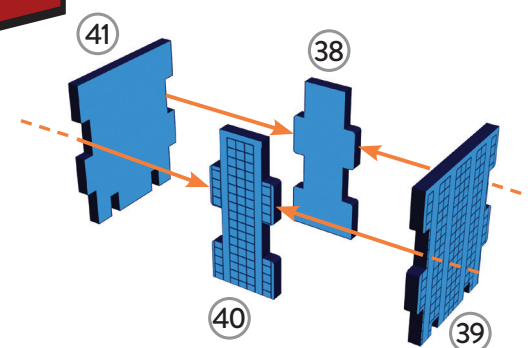

26

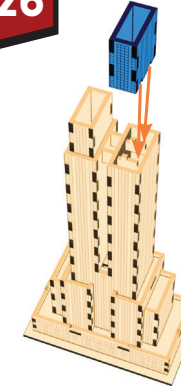

27

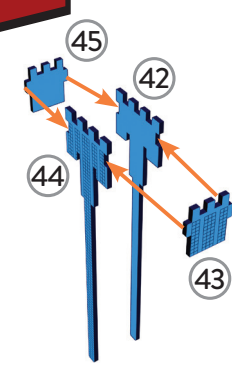

28

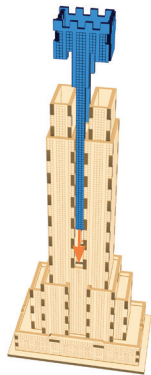

29



Be extra careful punching out these pieces. Use a pen or pencil to help if you need it.

30

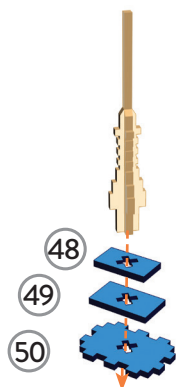

31

