

THUNDERBIRD

BUILDING INSTRUCTIONS



Manufactured in Shaoguan, China



COPYRIGHT © 2018 WARNER BROS. ENTERTAINMENT INC.
FANTASTIC BEASTS AND WHERE TO FIND THEM CHARACTERS, NAMES
AND RELATED INDICIA ARE © & TM WARNER BROS. ENTERTAINMENT INC.
WB SHIELD: TM & © WB. J.K. ROWLING'S WIZARDING WORLD™
J.K. ROWLING AND WARNER BROS. ENTERTAINMENT INC.
PUBLISHING RIGHTS © JKR. (S18)

READ BEFORE ASSEMBLING:

- Go through the instructions one step at a time.
- Don't punch out all of the pre-cut parts at once.
- Plywood thickness and color may vary.
- While not necessary, glue may be applied if desired.
- If you have trouble punching out the small pieces from the board, use tweezers or a toothpick to help.
- Adult supervision recommended.

WARNING: CHOKING HAZARD -
CONTAINS SMALL PARTS.
NOT FOR CHILDREN UNDER 3 YRS.

1



Find pieces 1 and 2 on the board.

2

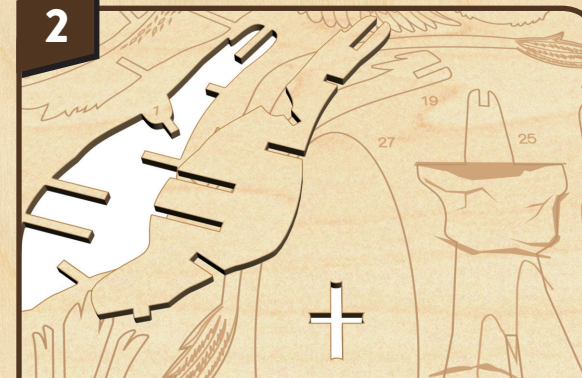

Pop out only these two pieces from the board.

3

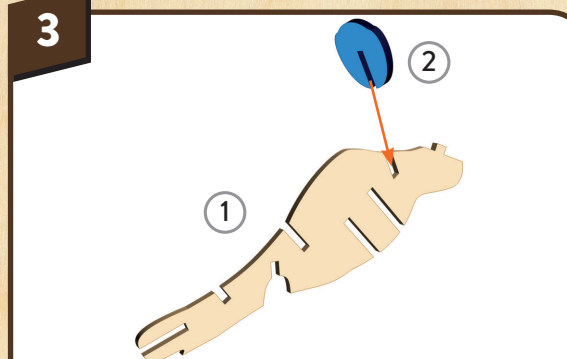

To put the two pieces together, match up the slots on each piece. Slide together.

4

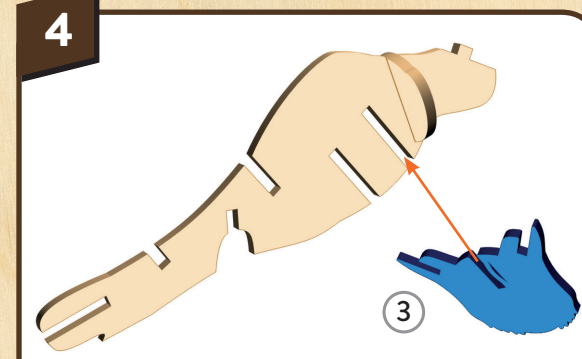

Continue assembling by putting pieces together in numerical order.

5

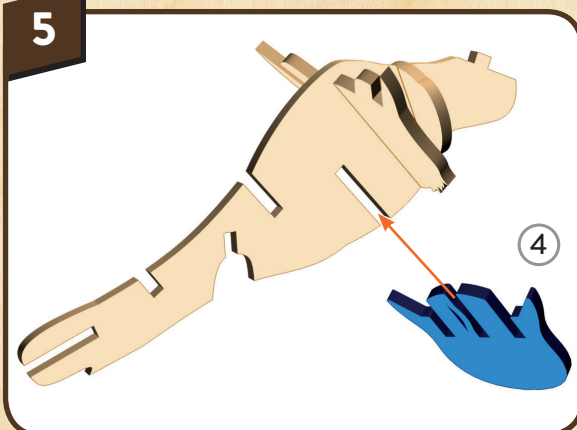

6

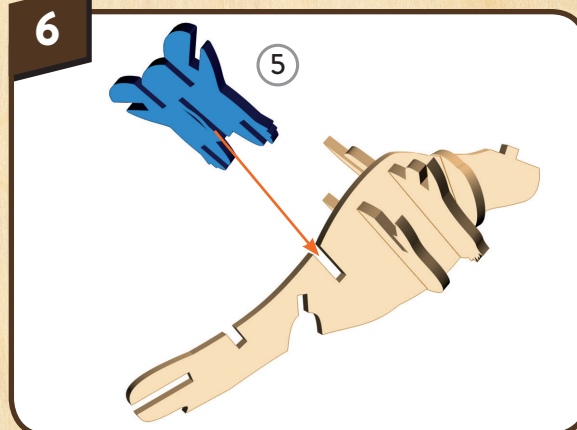

7

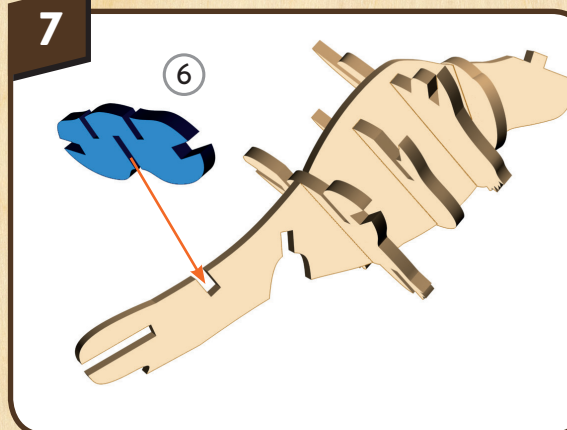

8

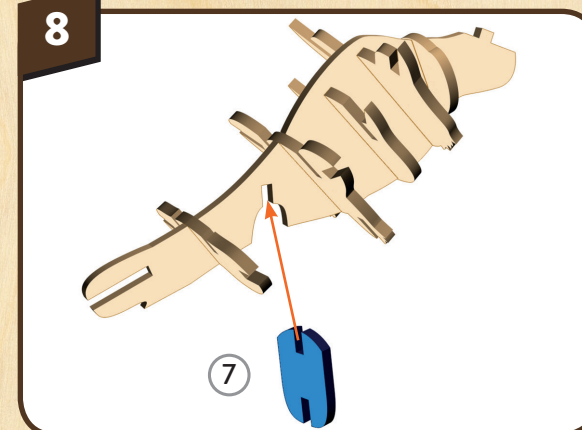

9

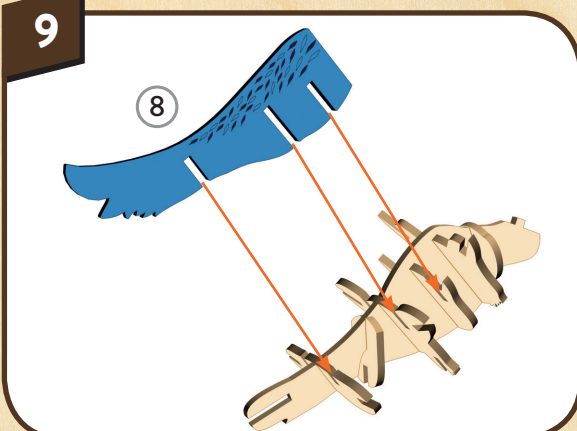

10

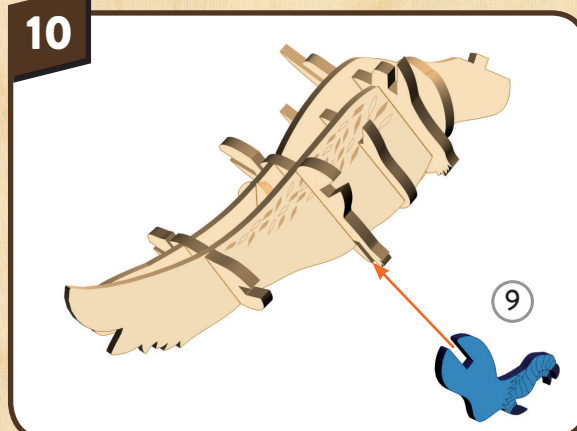

11

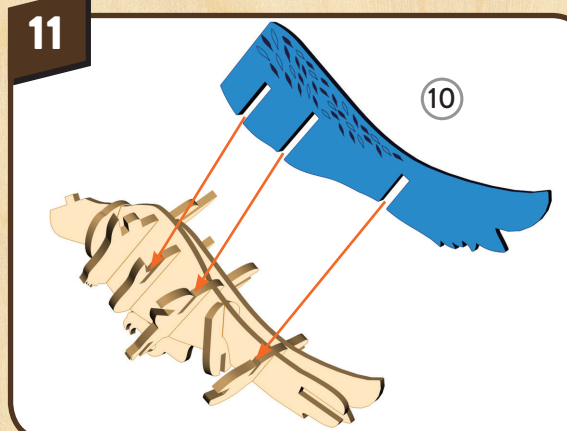

12

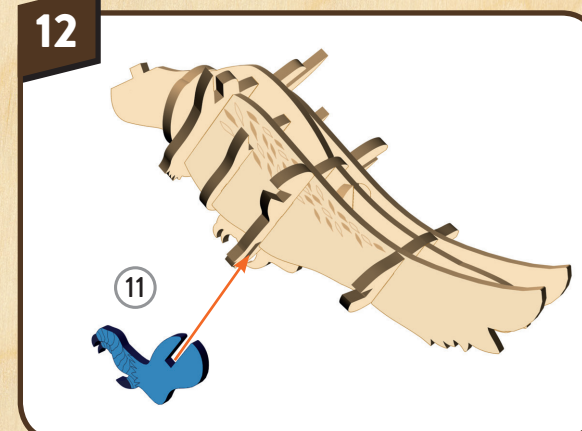

13

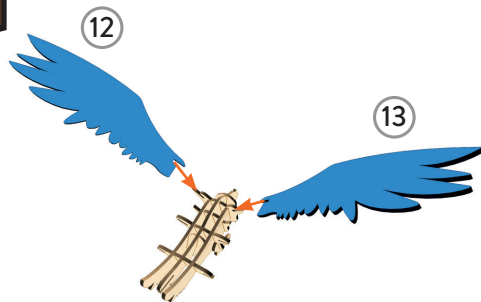

Pay careful attention to the orientation of these pieces. The engravings should be facing down and the flat edges should be at the front of the model.

14

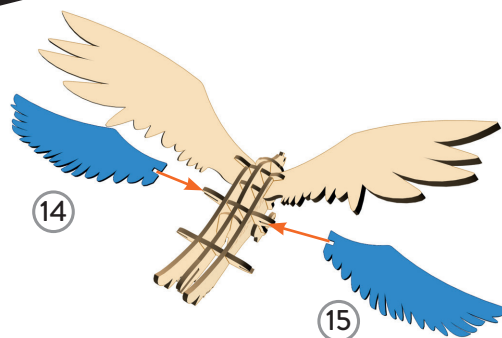

15

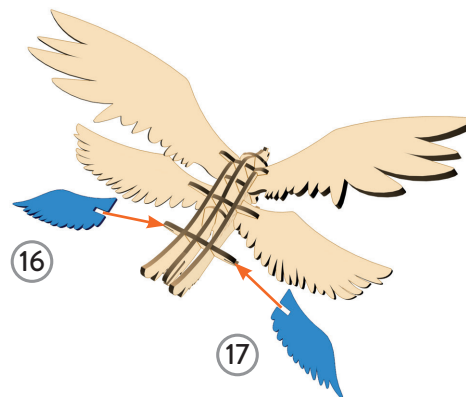

16

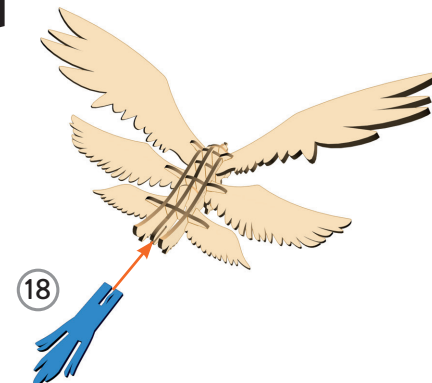

17

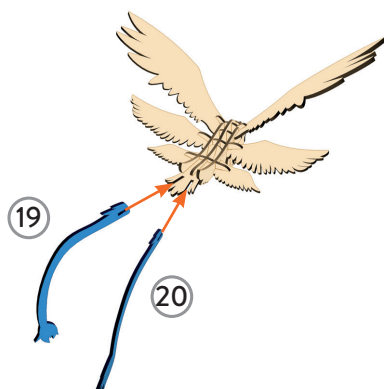

18



19

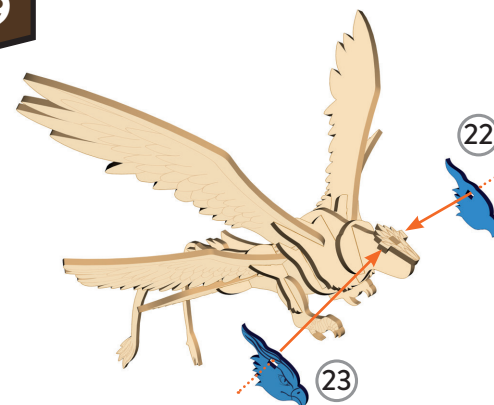

20

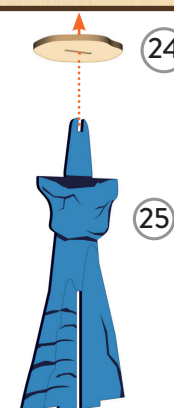

21

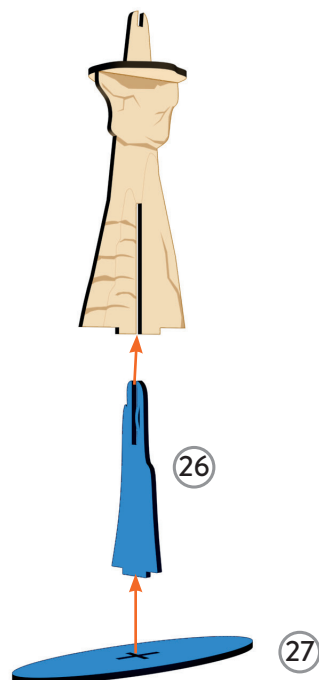

22

