

LIGHTNING MCQUEEN

BUILDING INSTRUCTIONS



READ BEFORE ASSEMBLING:

- Go through the instructions one step at a time.
- Don't punch out all of the pre-cut parts at once.
- Plywood thickness and color may vary.
- While not necessary, glue may be applied if desired.
- If you have trouble punching out the small pieces from the board, use tweezers or a toothpick to help.
- Adult supervision recommended.

WARNING: CHOKING HAZARD - CONTAINS SMALL PARTS. NOT FOR CHILDREN UNDER 3 YRS.

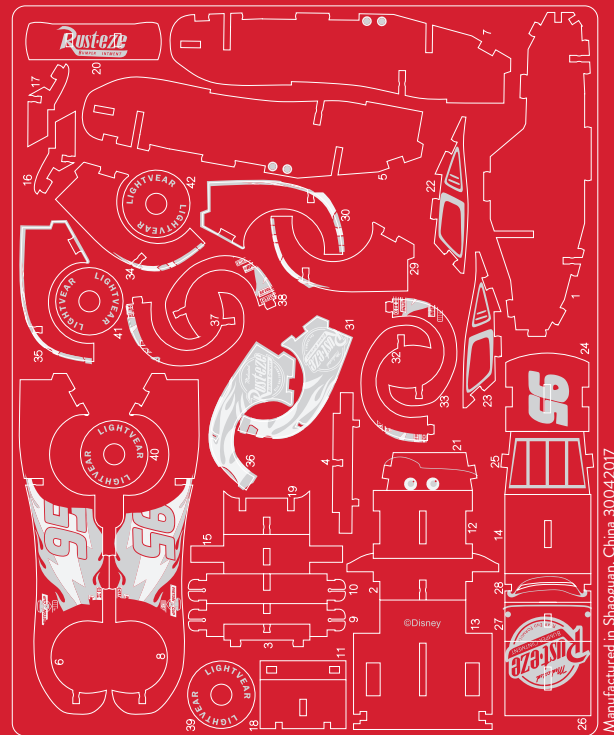

INCREDBUILDS™ COPYRIGHT © INSIGHT EDITIONS, LP, 2017
MATERIALS AND CHARACTERS FROM THE MOVIE CARS 3
COPYRIGHT © 2017 DISNEY ENTERPRISES, INC. AND Pixar.
ALL RIGHTS RESERVED.

1

Find pieces 1 and 2 on the board.

2

Pop out only these puzzle pieces from the board.

3

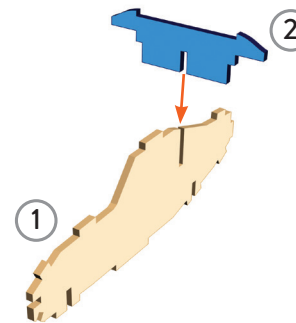

4

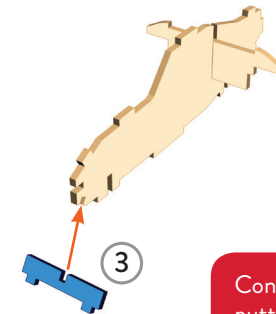

Continue assembling by putting pieces together in numerical order.

5

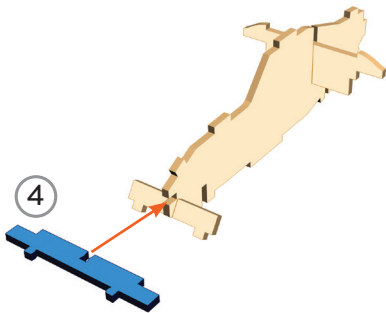

6

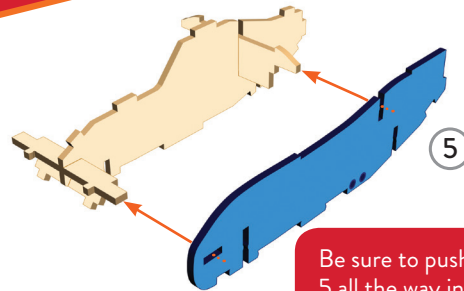

Be sure to push piece 5 all the way in so that the front is flush with piece 3.

7

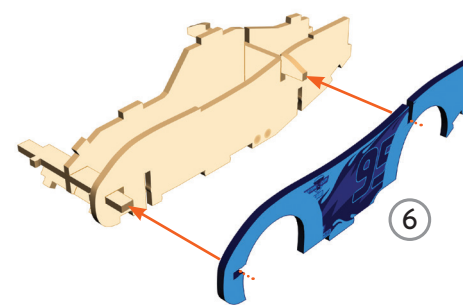

8

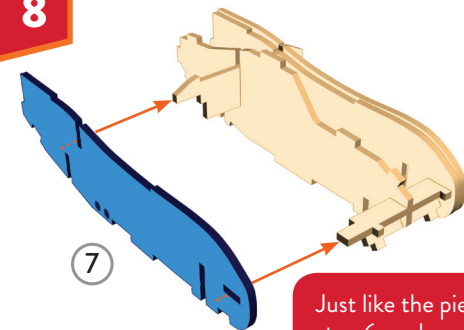

Just like the piece in step 6, make sure to push piece 7 all the way in.

9

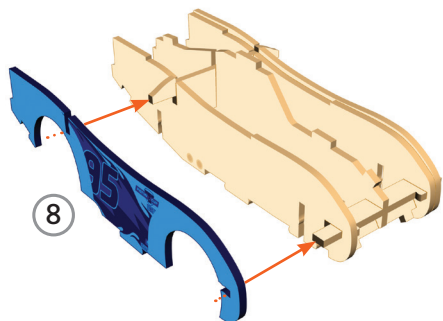

10

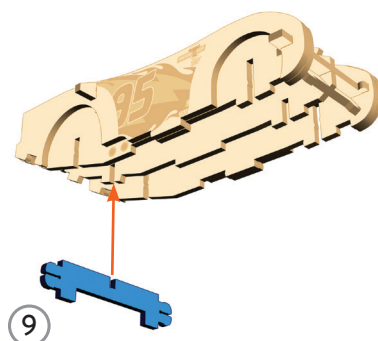

11

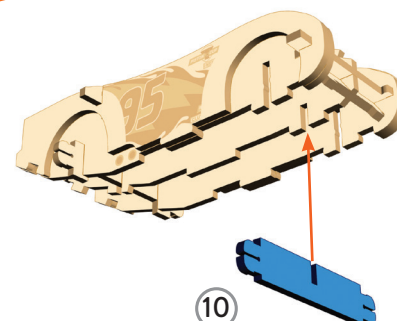

12

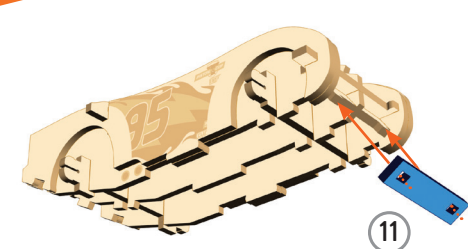

13

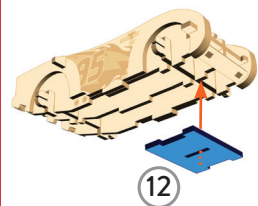

14

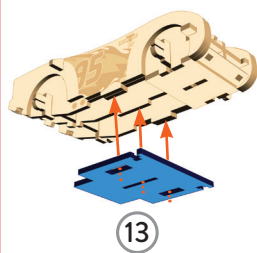

15

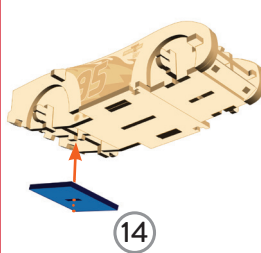

16

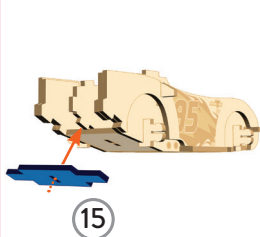

17

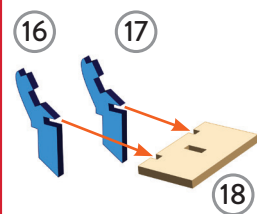

18

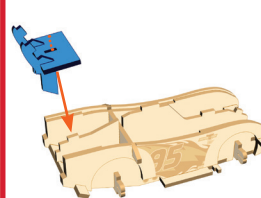

19

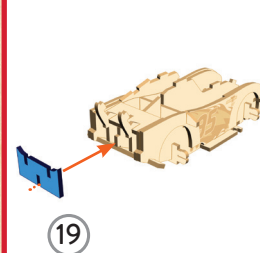

20

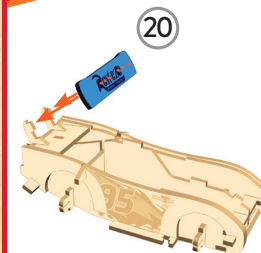

21

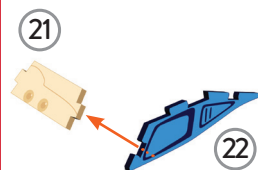

22

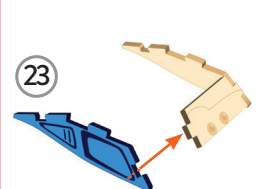

23

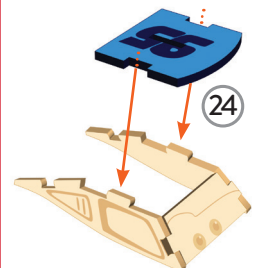

24

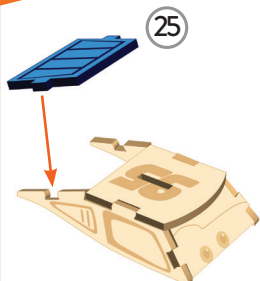

25

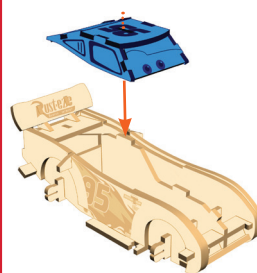

26

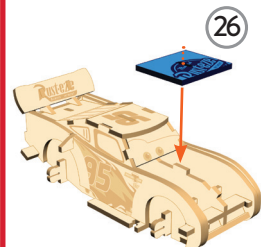

27

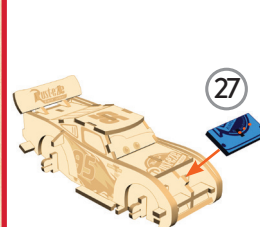

28

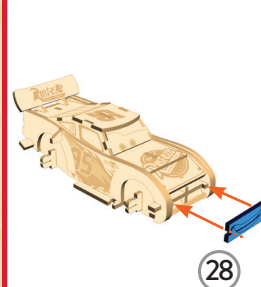

29

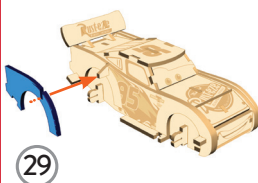

30

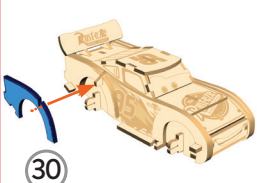

31

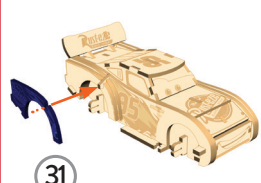

32

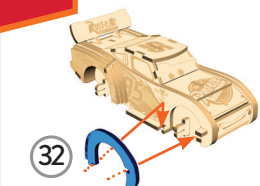

Attach the bottom notch of piece 32 first and then slide on to the car.

33

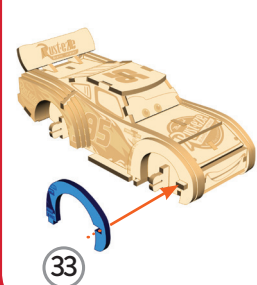

34

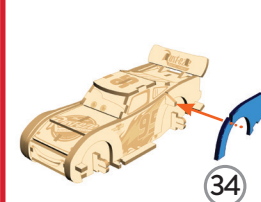

35

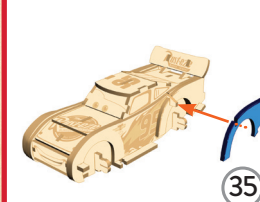

36

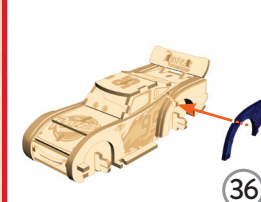

37

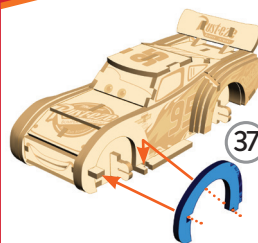

Attach the bottom notch of piece 37 first and then slide on to the car.

38

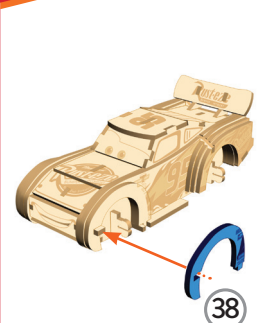

39

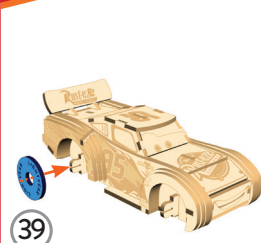

40

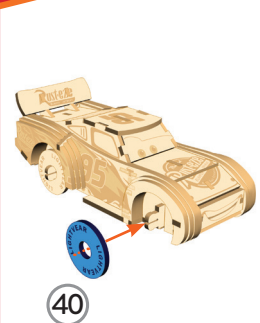

41

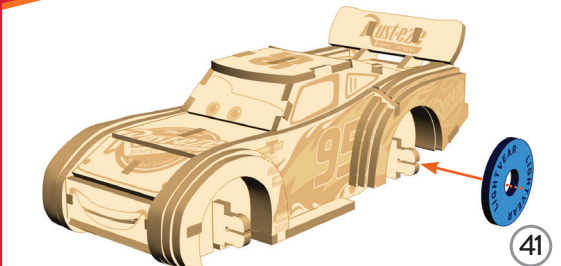

42

