

NUTCRACKER

BUILDING INSTRUCTIONS

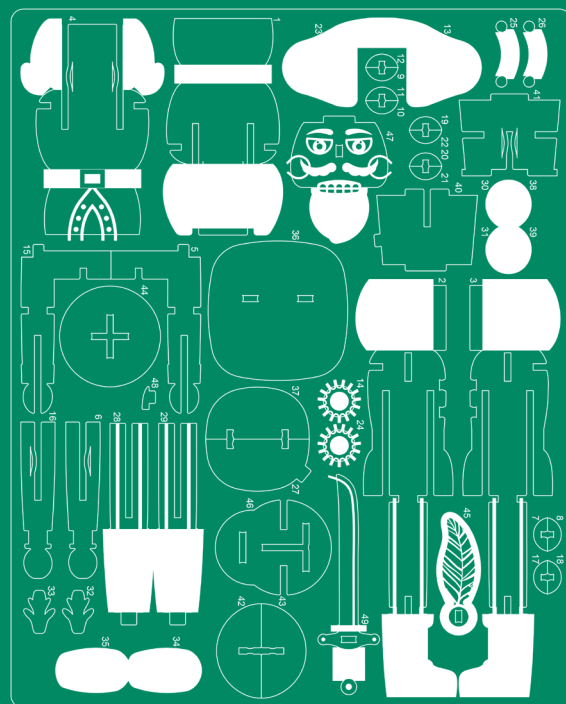
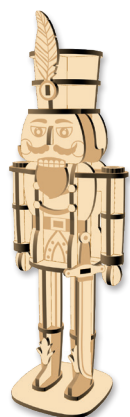

Manufactured in Shaoguan, China Lot # 58072017

READ BEFORE ASSEMBLING:

- Go through the instructions one step at a time.
- Don't punch out all of the pre-cut parts at once.
- Plywood thickness and color may vary.
- While not necessary, glue may be applied if desired.
- If you have trouble punching out the small pieces from the board, use tweezers or a toothpick to help.
- Adult supervision recommended.

WARNING: CHOKING HAZARD - CONTAINS SMALL PARTS. NOT FOR CHILDREN UNDER 3 YRS.

MAKE IT YOUR OWN

Before you start building and decorating your model, make a plan. Do you want to make a replica of the project below or create something of your own design? Anything goes!

PLAN

For this project, you will want to paint a few pieces separate from the model: hat, face, sword, and base.

TECHNIQUES

Use different sized of paintbrushes for different needs. You'll want a larger brush for the larger sections of color such as the hat, base, and pants. You should use a medium brush for the smaller sections, like the coat, hair, and boots. Use the tiniest brush you can find for the details on the face and coat.



COLORS

Classic holiday colors such as red, green, and gold are perfect for the iconic nutcracker. But don't forget basic black and white either. A light peach color will look nice for the face.



1



Find pieces 1 and 2 on the board.

2

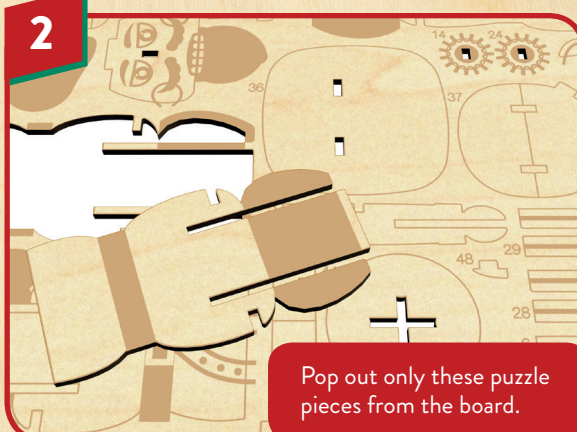

Pop out only these puzzle pieces from the board.

3

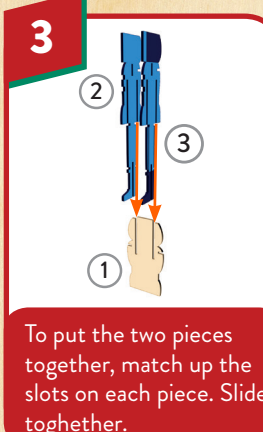

To put the two pieces together, match up the slots on each piece. Slide together.

4

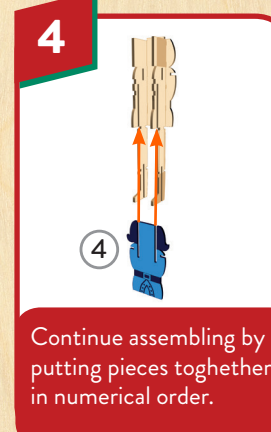

Continue assembling by putting pieces together in numerical order.

5

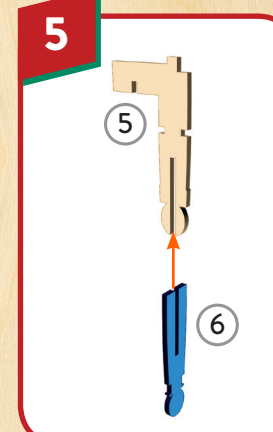

6

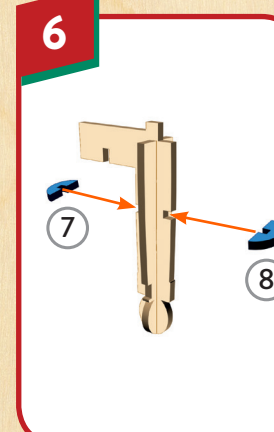

7

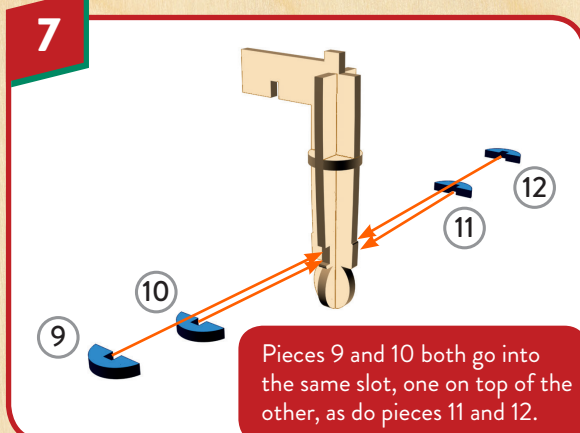

Pieces 9 and 10 both go into the same slot, one on top of the other, as do pieces 11 and 12.

8

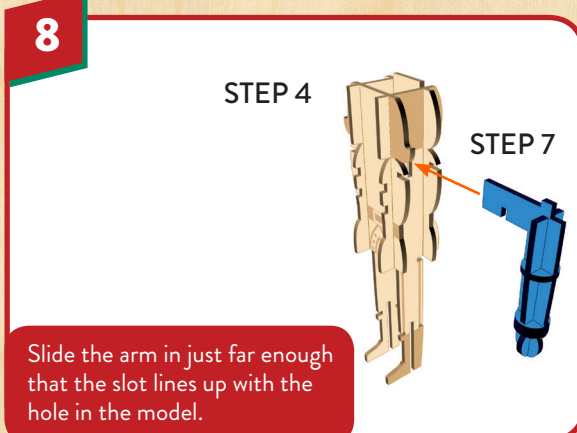

STEP 4

STEP 7

Slide the arm in just far enough that the slot lines up with the hole in the model.

9

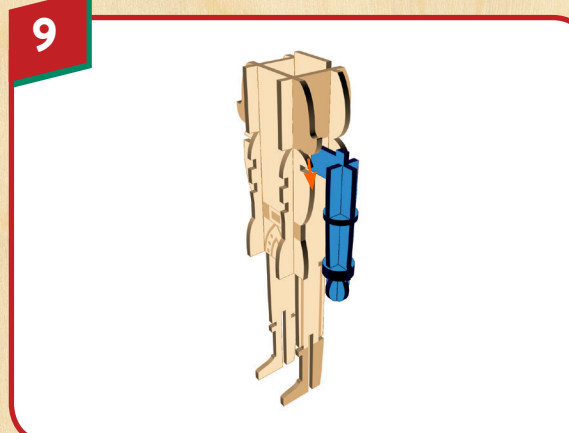

10

