

SLOTH

BUILDING INSTRUCTIONS

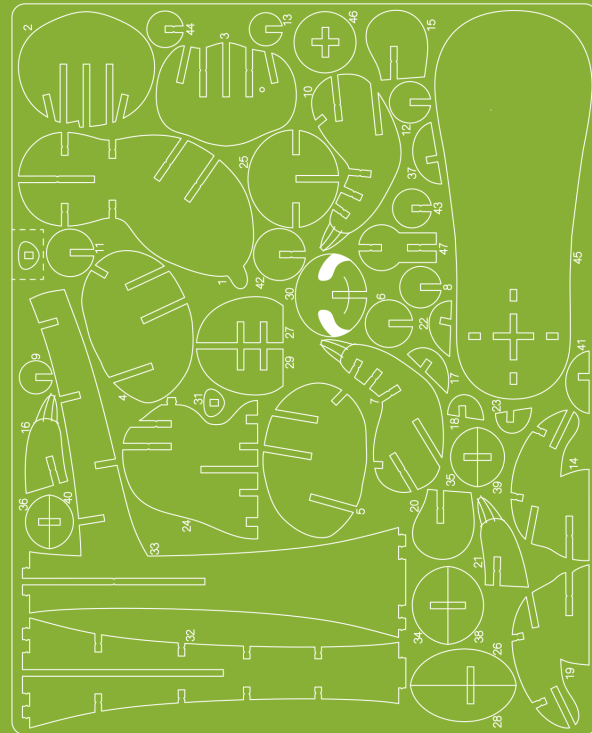
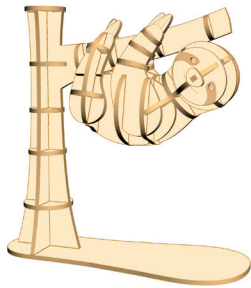

Manufactured in Shaogun, China 84072017

READ BEFORE ASSEMBLING:

- Go through the instructions one step at a time.
- Don't punch out all of the pre-cut parts at once.
- Plywood thickness and color may vary.
- While not necessary, glue may be applied if desired.
- If you have trouble punching out the small pieces from the board, use tweezers or a toothpick to help.
- Adult supervision recommended.

WARNING: CHOKING HAZARD -
CONTAINS SMALL PARTS.
NOT FOR CHILDREN UNDER 3 YRS.

1

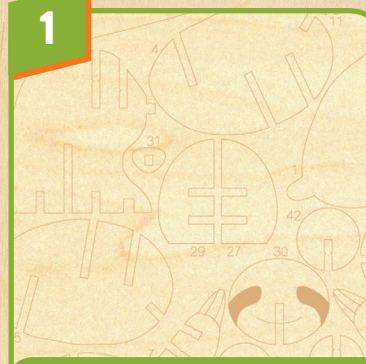

Find pieces 1 and 2 on the board.

2



Pop out only these puzzle pieces from the board.

3

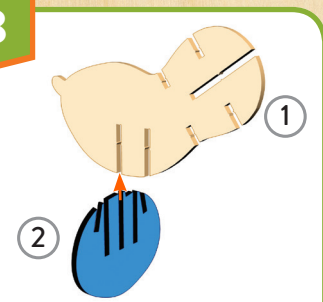

To put the two pieces together, match up the slots on each piece. Slide together.

4

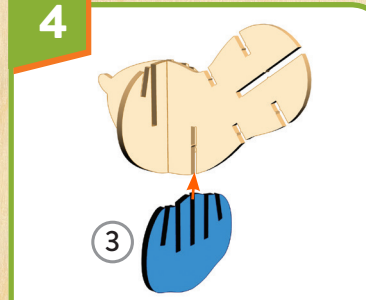

Continue assembling by putting pieces together in numerical order.

5

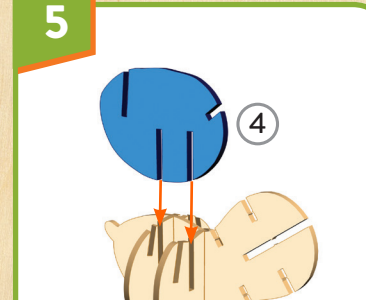

6

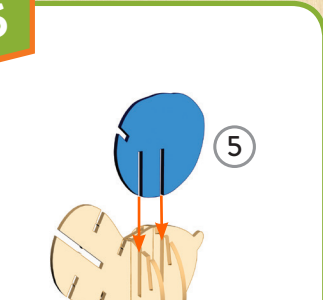

7

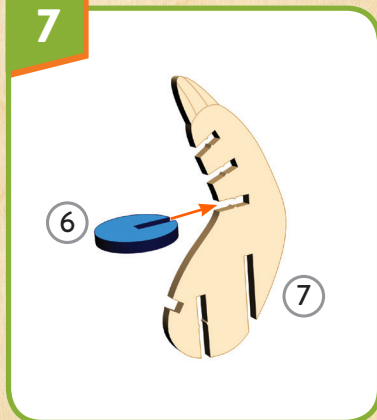

8



9



10

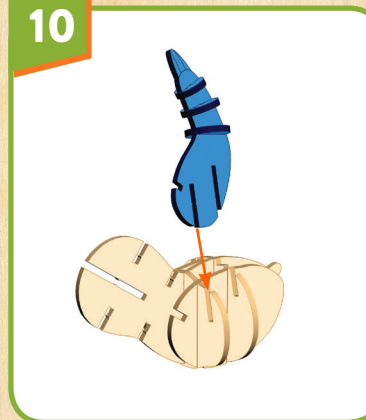

11

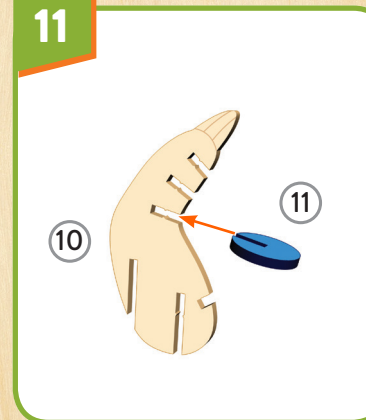

12

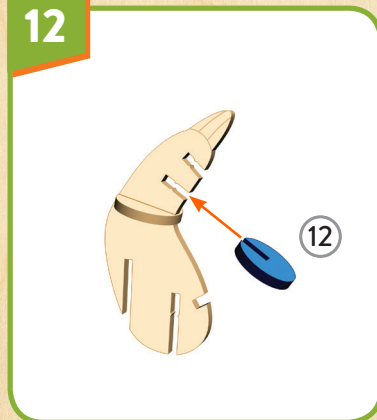

13



14

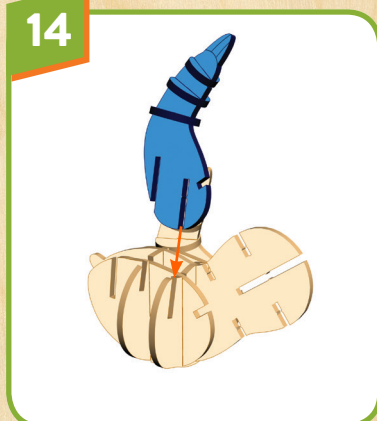

15



16

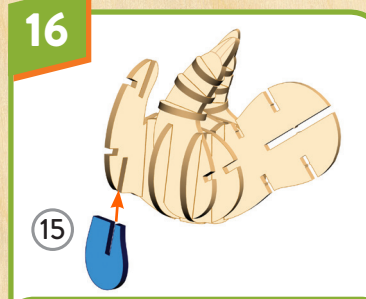

Pay careful attention to the orientation of piece 15. The thinner half should be on the right side of the piece.

17

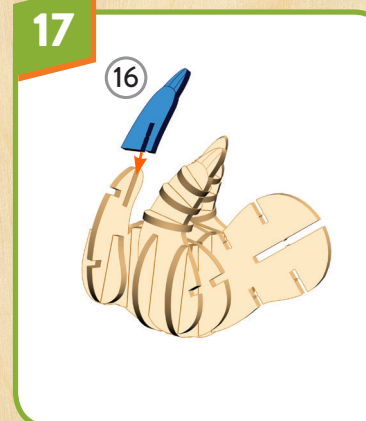

18



