

# GORILLA BUILDING INSTRUCTIONS

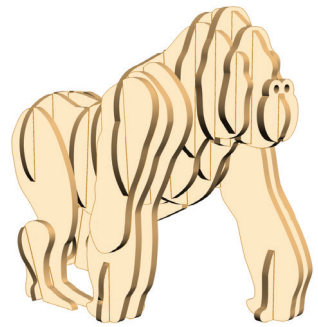

## READ BEFORE ASSEMBLING:

- Go through the instructions one step at a time.
- Don't punch out all of the pre-cut parts at once.
- Plywood thickness and color may vary.
- While not necessary, glue may be applied if desired.
- If you have trouble punching out the small pieces from the board, use tweezers or a toothpick to help.
- Adult supervision recommended.

**WARNING: CHOKING HAZARD -  
CONTAINS SMALL PARTS.  
NOT FOR CHILDREN UNDER 3 YRS.**

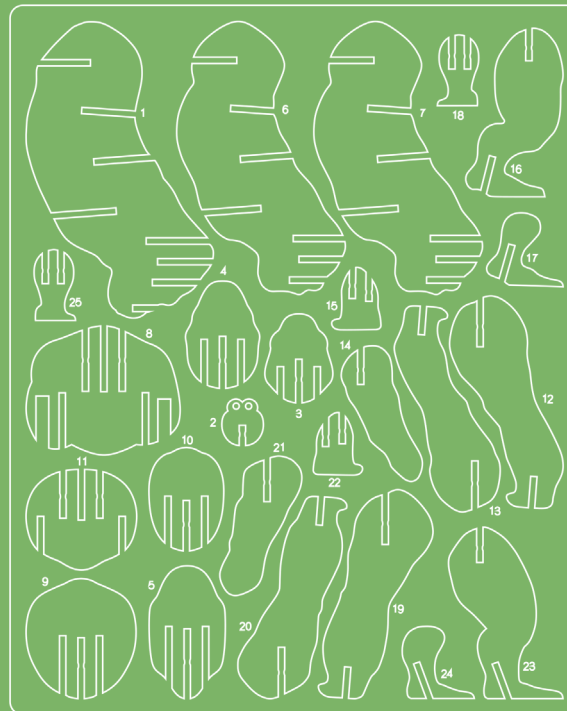

INCREDIBUILD™ COPYRIGHT © INSIGHT EDITIONS, LP, 2018.

Manufactured in Shaoguan, China 2702018

1

Find pieces 1 and 2 on the board.

2

Pop out only these puzzle pieces from the board.

3

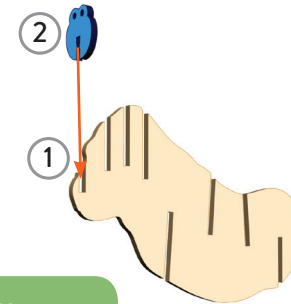

To put the two pieces together, match up the slots on each piece. Slide together.

4

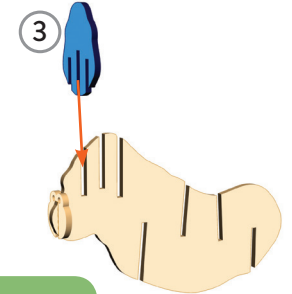

Continue assembling by putting pieces together in numerical order.

5

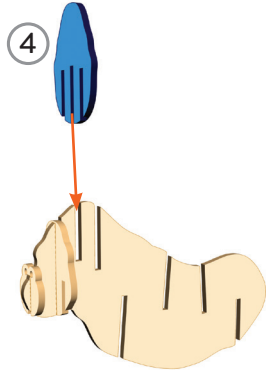

6

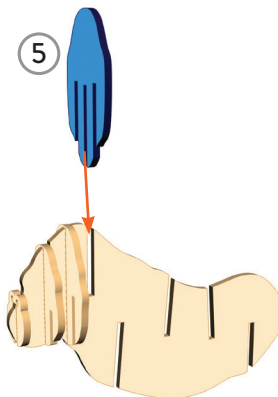

7

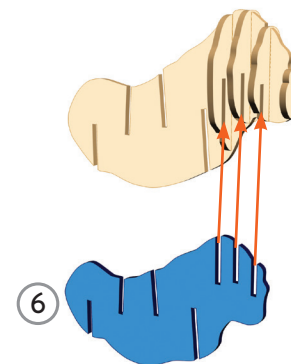

8

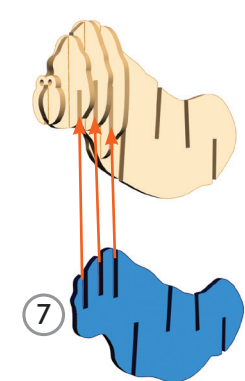

9

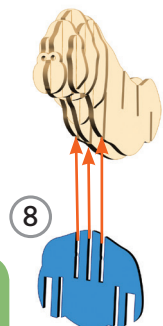

Pay careful attention to the orientation of piece 8. Make sure the smoother edge is on the right.

10

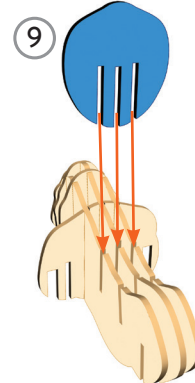

11

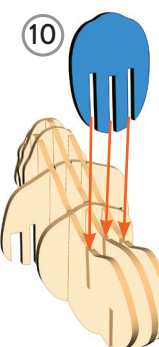

12

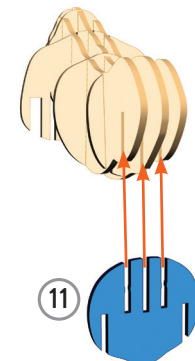

13

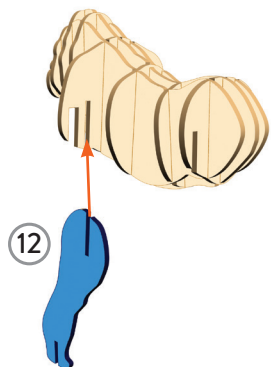

14

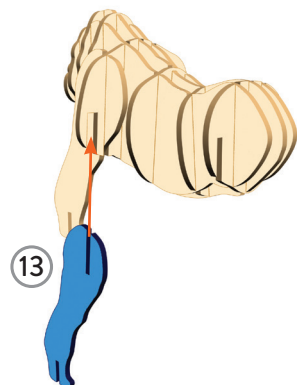

15

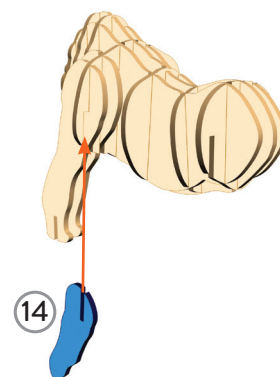

16

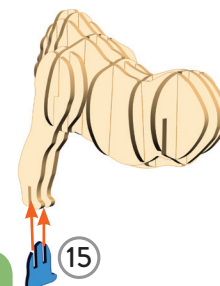

The small thumb sticking out of piece 15 should be pointing to the right.

17

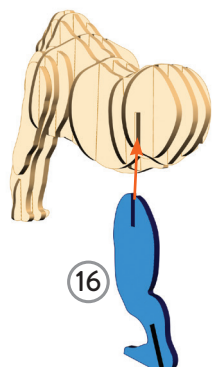

18

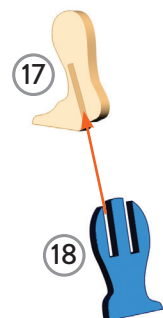

19

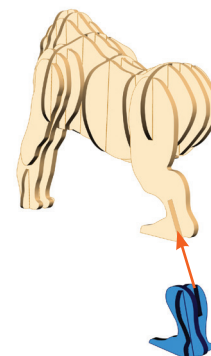

20

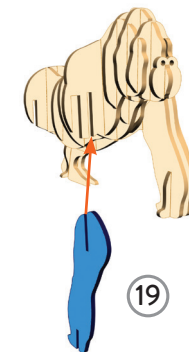

21

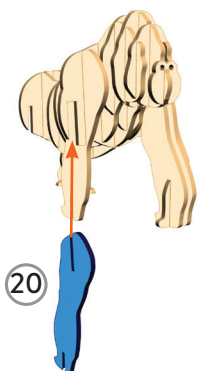

22

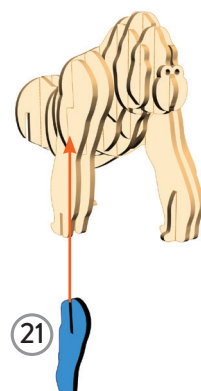

23

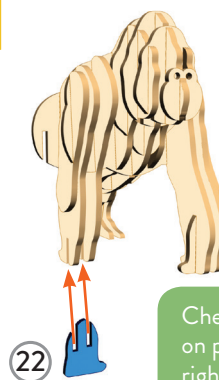

Check that the small thumb on piece 22 is pointing to the right of the model.

24

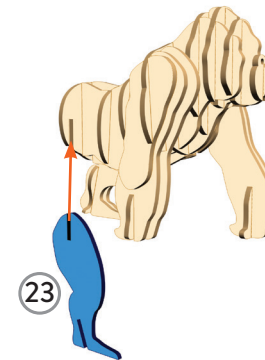

25

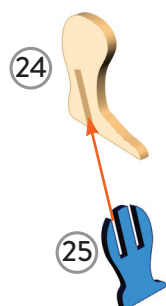

26

