

# RAVENCLAW™

## BUILDING INSTRUCTIONS



### READ BEFORE ASSEMBLING:

- Go through the instructions one step at a time.
- Don't punch out all of the precut parts at once.
- Plywood thickness and color may vary.
- While not necessary, glue may be applied if desired.
- If you have trouble punching out the small pieces from the board, use tweezers or a toothpick to help.
- Adult supervision recommended.

**WARNING: CHOKING HAZARD - CONTAINS SMALL PARTS. NOT FOR CHILDREN UNDER 3 YRS.**

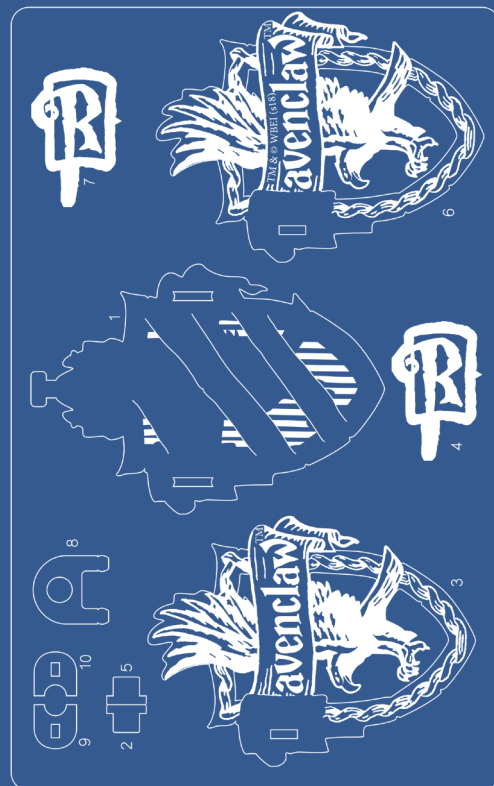

Manufactured in Shaoguan, China Lot 099092018



HARRY POTTER characters, names and related indicia are © & ™ Warner Bros. Entertainment Inc. WB SHIELD: © & ™ WBEL WIZARDING WORLD trademark and logo © & ™ Warner Bros. Entertainment Inc. Publishing Rights © JKR. (s18)

# MAKE IT YOUR OWN

Before you start building and decorating your model, make a plan. Do you want to make an exact replica of the project below or create something with your own Ravenclaw flair? Anything goes!

### PLAN

For this project, it's easiest to paint your model with all the layers of wood separated.

### TECHNIQUES

Use a fine paintbrush and take your time, especially with the smaller engraved details. To give your model more depth, use darker shades of paint for shadows and lighter shades for highlights.



### COLORS

Start by painting the background of the crest a light blue, and then paint the thick diagonal stripes and every other vertical stripe with a slightly darker blue. Use the same light blue as the background for the banner over the front of the crest, and add some shading with darker blue. Next, use a very fine brush with black paint or a black pen to fill in the Ravenclaw letters and outline the banner. Paint the rest of the crest borders and the raven bronze. Finish by using either black paint or black pen to accent the lines and shadows around the frame and on the raven.



1



Find pieces 1 and 2 on the board.

2



Pop out only these puzzle pieces from the board.

3

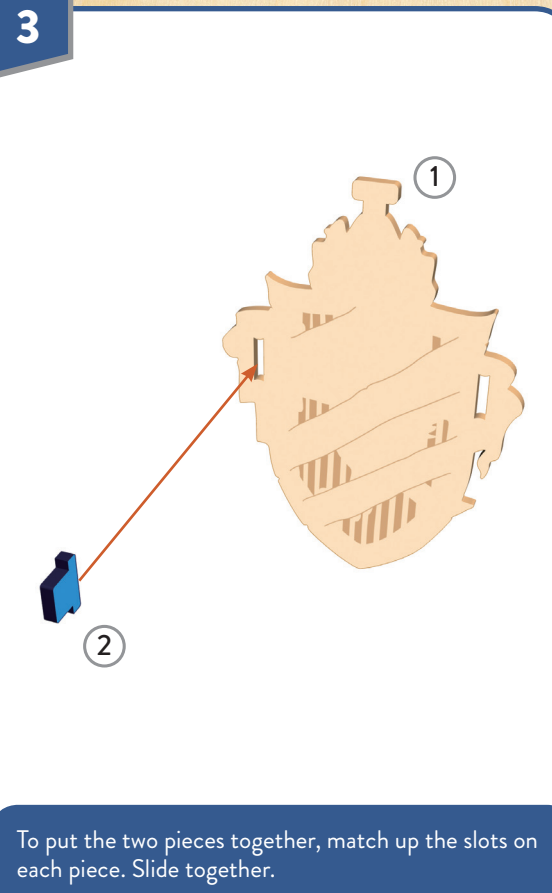

To put the two pieces together, match up the slots on each piece. Slide together.

4



Continue assembling by putting pieces together in numerical order.



5

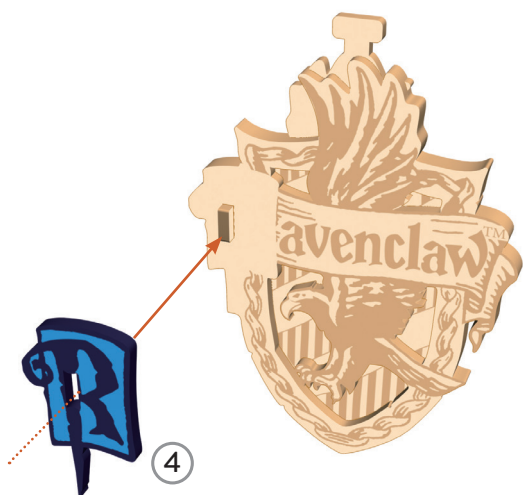

6

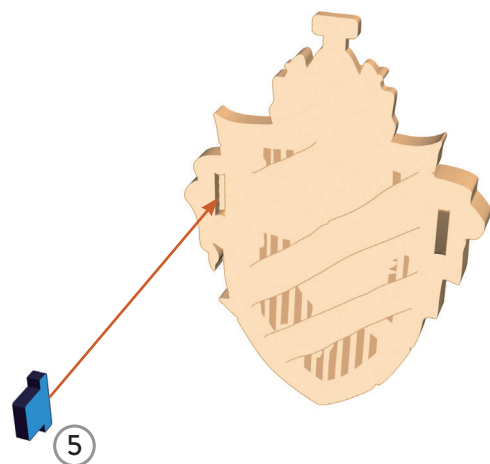

7



8

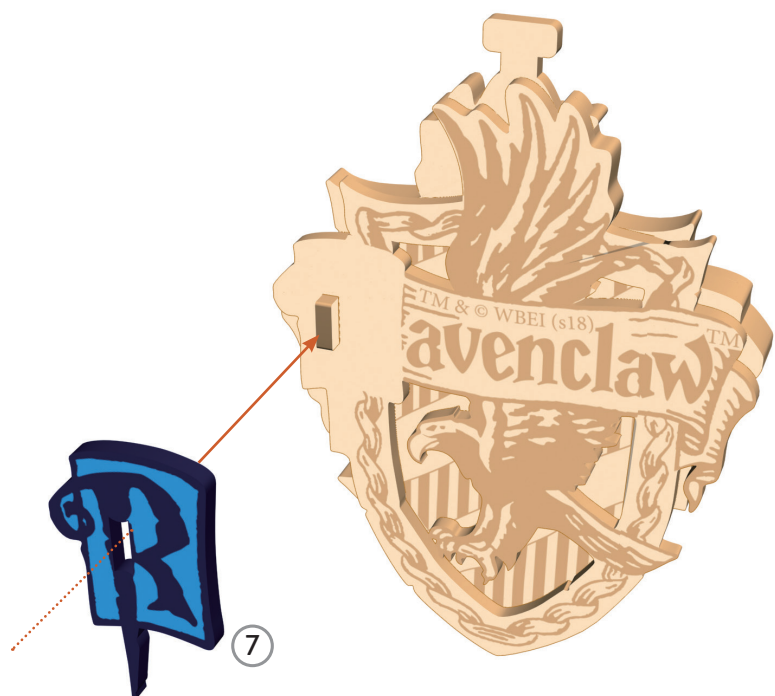

9

